



## BXUVC.J900 Fire-resistance Ratings

[Page Bottom](#)

### Fire-resistance Ratings

[See General Information for Fire-resistance Ratings](#)

## Design No. J900

January 30, 2013

**Restrained Assembly Rating — 2 h**

**Unrestrained Assembly Rating — 1-1/2 and 2 h (See Item 1)**

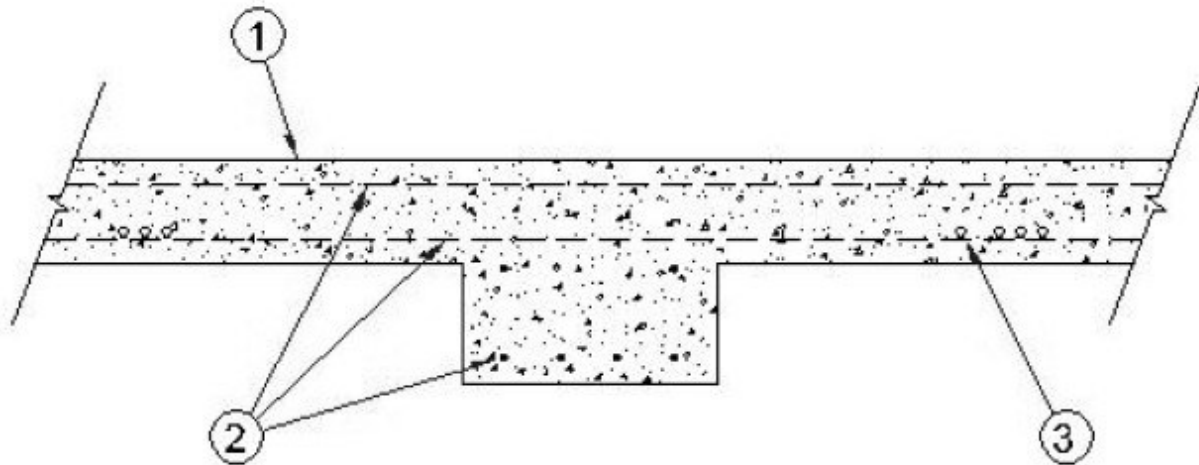

1. **Normal Weight Reinforced Concrete** — Reinforced slab and beam designed in accordance with the current edition of CSA A23.3, Design of Concrete Structures. Carbonate aggregate, minimum compressive strength of 25 MPa. Minimum slab thickness and reinforcement cover specified in the table below:

Restrained Assembly Rating, h	Unrestrained Assembly Rating, h	Min Total Slab Thickness, mm	Min Concrete Cover for Positive Reinforcement, mm
2	1-1/2	150	25
2	2	150	38

2. **Steel Reinforcement** — Various sized Grade 280 and Grade 420 deformed steel bars located as required by CSA A23.3 for positive and negative reinforcement. Minimum concrete cover for positive reinforcement as described in Item 1.

3. **Non-Metallic Plumbing Components (CEYDC)** — Nominal 12.7 mm through 50.8 mm O.D. tubing, evenly distributed and tied to the top side of the positive reinforcing bars. The tubing may be placed inside a flexible or rigid polyethylene or rigid PVC sleeve. The tubing may penetrate the floor slab through a sill plate and into a stud cavity of a wall as necessary. Tube bends may be supported by suitably sized PVC elbows. The maximum amount of tubing shall be as specified in the table below:

Restrained Assembly Rating, h	Unrestrained Assembly Rating, h	Max. volume of tube per cubic metre of concrete, %
2	1-1/2 or 2	0.925

**BOW PLASTICS LTD** — Types SuperPex, Oxypex, Bow CPVC FlowGuard Gold, Bow Superflo CPVC

**HEATLINK GROUP INC** — Types Purelink PEXa, Heatlink PEXa, Purelink Plus

**IPEX INC** — Type CPVC AquaRise

**REHAU CONSTRUCTION L L C** — Types RaupeX Non-barrier PE-Xa, RaupeX O2-barrier PE-Xa, RaupeX UV-Shield PE-Xa, MUNICIPEX

**VANGUARD PIPE & FITTINGS LTD** — Types Vanex, CanPLUMB, CanPEX, CanFLEX, Vanex Plus, Vanex BPEX, Vanex Barrier, CanRAY, Vanex/ViegaPex Ultra, Canpex UV Plus and Canpex UV+

Last Updated on 2013-01-30

---

[Questions?](#)

[Print this page](#)

[Terms of Use](#)

[Page Top](#)

Copyright © 2013 Underwriters Laboratories of Canada Inc.

When the UL Leaf Mark is on the product, or when the word "Environment" is included in the UL Mark, please search the [UL Environment database](#) for additional information regarding this product's certification.

The appearance of a company's name or product in this database does not in itself assure that products so identified have been manufactured under ULC's Follow-Up Service. Only those products bearing the ULC Mark should be considered to be Listed and covered under ULC's Follow-Up Service. Always look for the Mark on the product.

ULC permits the reproduction of the material contained in the ULC Online Directories subject to the following conditions: 1. The Guide Information, Designs and/or Listings (files) must be presented in their entirety and in a non-misleading manner, without any manipulation of the data (or drawings). 2. The statement "Reprinted from the ULC Online Directories with permission from Underwriters Laboratories of Canada Inc." must appear adjacent to the extracted material. In addition, the reprinted material must include a copyright notice in the following format: "Copyright © 2013 Underwriters Laboratories of Canada Inc."

An independent organization working for a safer world with integrity, precision and knowledge.

